

Product Zebra Technologies Corporation
Producer 1 Zebra Plaza
Holtsville, NY 11742

Product TC15/TN28 TOUCH COMPUTER
Description

Hazardous Substances and Preparations The materials used in this product are RoHS compliant. This product contains the following items that may require special handling:

- PC Boards
- LCD Display
- Battery

Batteries This product contains a removable lithium-ion (Li-Ion) type battery located at the back of the product. The battery in Windows versions of this product clip into the back of the product and can be removed without the use of tools. Battery removal instructions and method of attachment details can be found in the [Quick References Guides](#). This battery must be disposed of in accordance with local regulations.

Packaging The packaging materials used for this product do not contain any of the banned materials listed in the EU packaging directive.

The printed user documentation included with this product is produced on paper with 50% or more recycled content that has not been bleached with chlorine.

Information on the assessment of the packaging scheme for this or other Zebra products can be found at: <http://www.zebra.com/environment>.

Recycling Information Zebra Technologies offers product recycling programs in certain geographic areas. To determine if a program is available for this product in your area, please refer to our web site at: <http://www.zebra.com/environment>.

This product is designed with the following features to enhance recycling:

- Glues and adhesives have been eliminated from product construction where feasible.
- Use of common fasteners and/or snap-in features
- Plastic parts weighing more than 25g are marked according to ISO 11469 standards except where impractical.

TC15/TN28 TOUCH COMPUTER

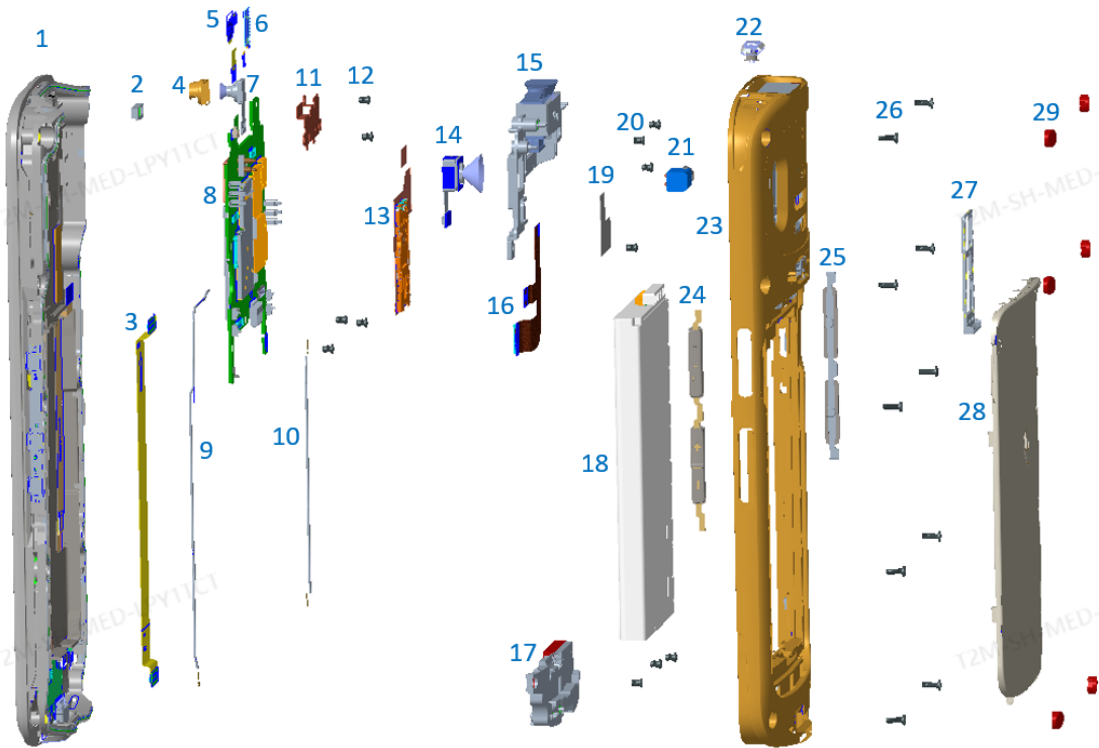

1. Front cover+TP asm
2. P-sensor rubber
3. Main FPC
4. Front camera rubber
5. Receiver FPC
6. P-sensor FPC
7. Front camera
8. Main PCBA
9. Black RF cable
10. White RF cable
11. Scanner support steel
12. Screws fix main PCBA*5
13. SIM FPC
14. Rear camera
15. Scanner engine asm
16. Scanner FPC
17. SPK Box
18. Battery
19. Conductive fabric
20. Screws fix Frame*7
21. Vibrator
22. Power key
23. Rear housing asm
24. Volume key
25. PTT key
26. Screws fix rear cover*10
27. SIM tray
28. Battery cover
29. Screw cap

This document was compiled from information available at the time of publication and is issued only as an information source. No warranty as to accuracy or completeness is expressed or implied. This document is subject to change without notice.